

DIXI 70600 PCD & DIXI 70070 PCD

DIXI
polytool

NEW PCD MILLING CUTTERS

DEDICATED TO THE
FINISHING OF
WATCH COMPONENTS



swiss
made  since
1946  SWISS

Enjoy Swiss Precision

www.dixipolytool.com

DIXI 70600 PCD

Z = 1



FROM STOCK

STRAIGHT FLUTE SLOT DRILLS



Cu alloy Silver Gold	Cu alloy difficult to machine	Al	Plastic
----------------------------	-------------------------------------	----	---------

Roughing ●●●○○○ Finishing ●●●●●●

$D_{1 \pm 0.01}$	L_1	D_{h5}	L	PCD
0.50	1.00	3	38	398840
0.60	1.20	3	38	398841
0.70	1.40	3	38	398842
0.80	1.60	3	38	398843
0.90	1.80	3	38	398844
1.00	2.00	3	38	398845
1.10	2.20	3	38	398846
1.20	2.40	3	38	398847
1.30	2.60	3	38	398848
1.40	2.80	3	38	398849
1.50	3.00	3	38	398850
1.60	3.20	3	38	398851
1.70	3.40	3	38	398853
1.80	3.60	3	38	398854
1.90	3.80	3	38	398855
2.00	4.00	3	42	398856
2.50	5.00	6	42	398857
3.00	6.00	6	42	398858

FINISHING

- Outstanding sharpness thanks to the laser processing
- Polished flutes

PCD

- Special grade for the machining of watch components

GEOMETRY

- Reduced burrs due to straight teeth
- Reinforced body for a perfect hold of the PCD insert

DIXI 70070 PCD

Z = 1

PCD 3/4 ENGRAVING TOOLS

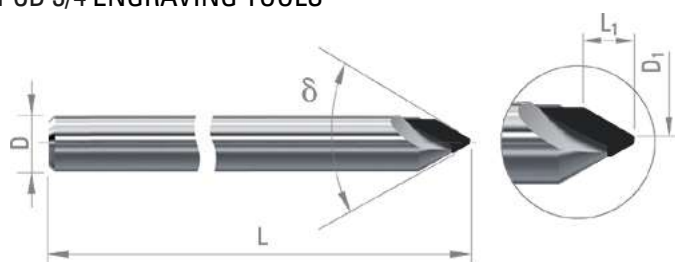

δ	L_1	D_{h5}	L	D_1	PCD
40°	3.50	3	38	0.05	413445
				0.10	345623
50°	2.70	3	38	0.05	367069
				0.10	367070
60°	2.20	3	38	0.05	413446
				0.10	413447
90°	1.20	3	38	0.10	413448
				0.20	413449

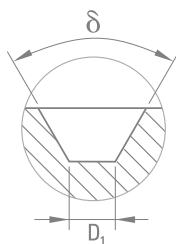

FINISHING

- Outstanding sharpness thanks to the laser processing

PCD

- Special grade for the machining of watch components

GEOMETRY

- 3/4 geometry for a perfect hold of the PCD insert

DIXI POLYTOOL SA

Av. du Technicum 37
CH-2400 Le Locle

T +41 (0)32 933 54 44

dixipoly@dixi.ch

www.dixipolytool.com